

Line

100-120-125-127

Comandi a pannello con corpo in tecnopolimero
Panel mounting actuators with technopolymer body

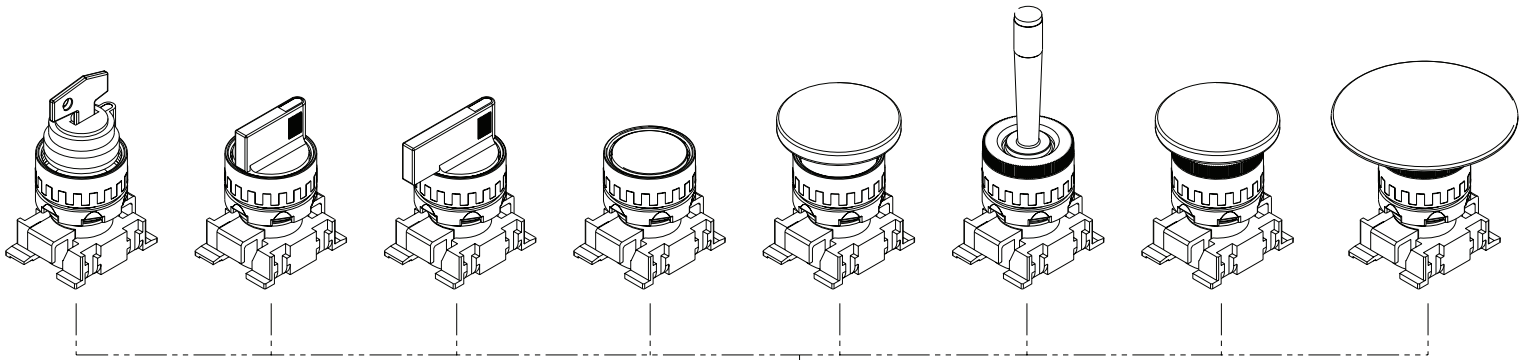

Misure di foratura Drilling measures

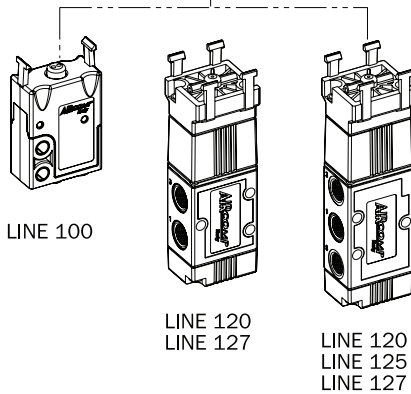
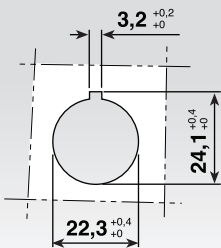

NB: I codici e le caratteristiche delle microvalvole linea 100 e valvole linea 120, 125 e 127, per comandi manuali a pannello, sono consultabili alle pagine 12, 29, 49 e 61.

NB: For codes and features of microvalves line 100 and valves line 120, 125 and 127, with manual panel mounting actuator, refer to page 12, 29, 49 and 61.

Selettore a chiave 2 posizioni, Corpo in tecnopolimero, elemento frontale rotondo.
2 Positions key selector. Technopolymer body, round front element.

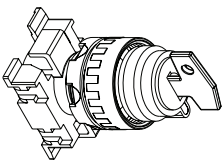

POSITION	CODE	REF.
	1003A00031	SELETTORE RT201N

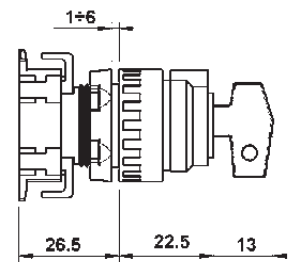

Selettore a leva corta 2 - 3 posizioni. Corpo in tecnopolimero, elemento frontale rotondo.
2 - 3 Positions short lever selector. Technopolymer body, round front element.

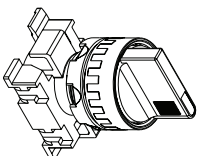

POSITION	CODE	REF.
	1003A00032	SELETTORE RT300N
	1003A00033	SELETTORE RT350N
	1003A00034	SELETTORE RT313N
	1003A00035	SELETTORE RT383N

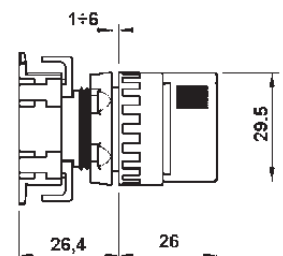





Line

100-120-125-127

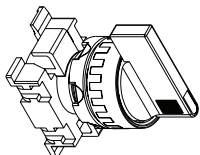
Comandi a pannello con corpo in tecnopolimero
Panel mounting actuators with technopolymer body

Selettore a leva lunga 2 - 3 posizioni.
Corpo in tecnopolimero, elemento frontale rotondo.
2 - 3 Positions long lever selector.
Technopolymer body, round front element.



POSITION	CODE	REF.
 1	1003A00036	SELETTORE RT400N
 1	1003A00037	SELETTORE RT450N
 1	1003A00038	SELETTORE RT413N
 2	1003A00039	SELETTORE RT483N

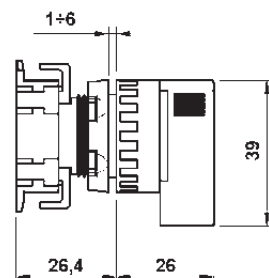

Pulsante protetto. Corpo in tecnopolimero, elemento frontale rotondo.
Protected push button. Technopolymer body, round front element.

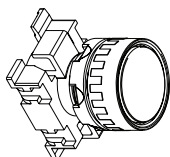

COLOR	CODE	REF.
-	1003A00040	PULSANTE RT010 ^(*)
bianco-white	1003A00047	PIASTRINA BIANCA - WHITE COVER
nero-black	1003A00048	PIASTRINA NERA - BLACK COVER
rosso-red	1003A00049	PIASTRINA ROSSA - RED COVER
blu-blue	1003A00019	PIASTRINA BLU - BLUE COVER
giallo-yellow	1003A00020	PIASTRINA GIALLA - YELLOW COVER
verde-green	1003A00021	PIASTRINA VERDE - GREEN COVER

^(*)Fornito senza piastrina

^(*)Provided without cover

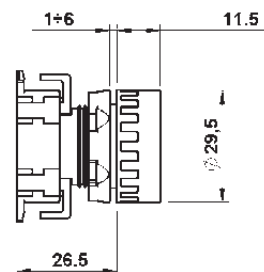

Fungo assiale. Corpo in tecnopolimero, elemento frontale rotondo.
Axial mushroom. Technopolymer body, round front element.

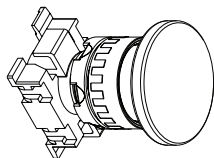

COLOR	CODE	REF.
rosso-red	1003A00041	FUNGO RT050R

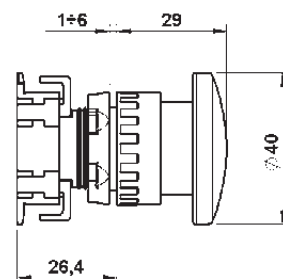

Line

100-120-125-127

Comandi a pannello con corpo in tecnopolimero
Panel mounting actuators with technopolymer body

Fungo oscillante Ø40. Corpo in tecnopolimero, elemento frontale rotondo.
Multi-directional mushroom Ø40. Technopolymer body, round front element.

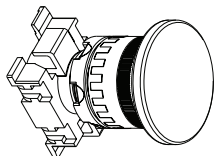

COLOR	CODE	REF.
rosso-red	1003A00043	FUNGO RT055R (ø 40)

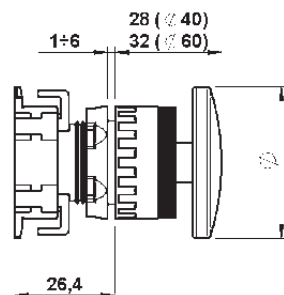

Fungo oscillante Ø60. Corpo in tecnopolimero, elemento frontale rotondo.
Multi-directional mushroom Ø60. Technopolymer body, round front element.

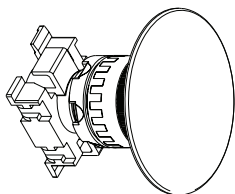

COLOR	CODE	REF.
rosso-red	1003A00045	FUNGO RT056R (ø 60)

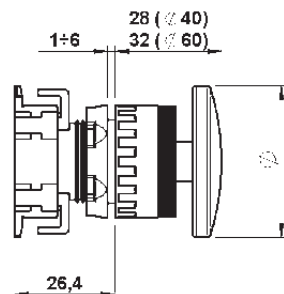

Leva oscillante. Corpo in tecnopolimero, elemento frontale rotondo.
Multi-directional lever. Technopolymer body, round front element.

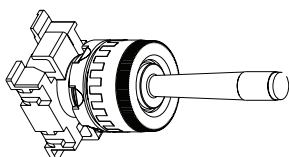

COLOR	CODE	REF.
rosso-red	1003A00046	LEVA RT054R

