

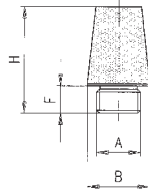

CARATTERISTICHE TECNICHE / TECHNICAL CHARACTERISTICS

Pressione massima / maximum pressure:	12 bar
Temperatura minima / minimum temperature:	-10°C
Temperatura massima / maximum temperature:	+80°C
Porosità media / porosity:	40%
Soglia di filtrazione / filtration threshold:	36 µm



A	F	B	H		Conf. Pack.
1/8	6	12	21	42.6	25
1/4	6	15	25	44	25
3/8	8	19	36	27.3	25
1/2	10	23	43	19	25
3/4	13	30	53	16	25
1"	15	37	63	16.6	10