

D12-16-20-25

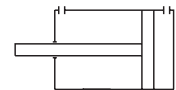

D32-40-50-63-80-100

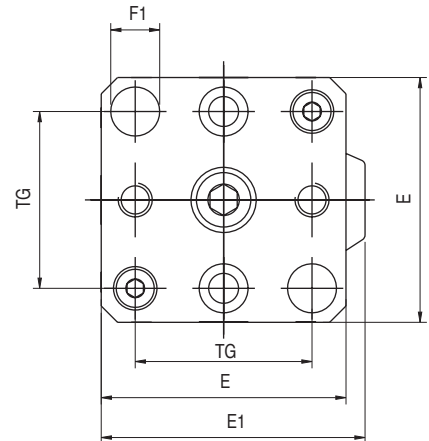
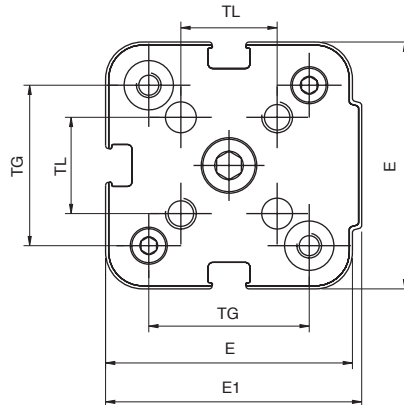
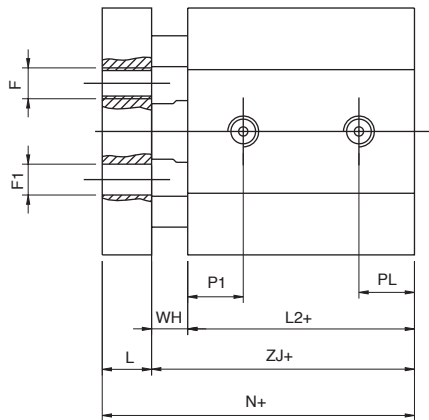

+= aggiungere la corsa += add stroke
 * = per corsa corta filetto passante * = Through threads only on small strokes

BFA
DOPPIO EFFETTO MAGNETICO ANTIROTAZIONE - DOUBLE-ACTING MAGNETIC ANTIROTATION

Ø mm.	A	BØ	C	DØ	E	E1	F	F1Ø	FBØ	RT	BG*	D2Ø	L	L2+	L3	MMØ	P1	PL	TG	TL	WH	ZJ+	N+
12	M3	6	3.5	4	29	30	M3	3.3	3.5	M4	12.5	5.5	5	28	3.5	6	7.5	7.5	18	9.9	6	34	39
16	M3	6	3.5	4	29	30	M3	3.3	3.5	M4	14.5	5.5	5	30.5	3.5	8	8.5	8.5	18	9.9	6	36.5	41.5
20	M3	6	3.5	6	36	37.5	M4	4	4.2	M5	16.5	7	8	31.5	4.5	10	9	9	22	12	6	37.5	45.5
25	M4	8	4.5	6	40	41.5	M5	5	4.2	M5	16.5	7	8	31.5	4.5	10	9	9	26	15.6	6	37.5	45.5
32	4.5	8	4.5	6	45	48.5	M5	8.5	5	M6	21.7	9	10	32	5.7	12	10	10	32.5	7	39	48	
40	4.5	8	4.5	6	52	57	M5	8.5	5	M6	21.7	9	10	38.5	5.7	12	11	11	38	7.2	45.7	55.5	
50	5.5	9	5.5	8	63.5	70.5	M6	10	6.8	M8	22.8	11	12	39	6.8	16	11	11	46.5	8.5	47.5	59	
63	5.5	9	5.5	8	77	84	M6	10	6.8	M8	22.8	11	12	46	6.8	16	11.5	11.5	56.5	8	54	66	
80	8.5	14	9	12	92	102	M8	13	8.5	M10	25	14	14	54	9	20	14	14	72	11	65	79	
100	8.5	14	9	12	113	126	M8	13	8.5	M10	25	14	14	65	9	25	17.5	17.5	89	12	77	91	