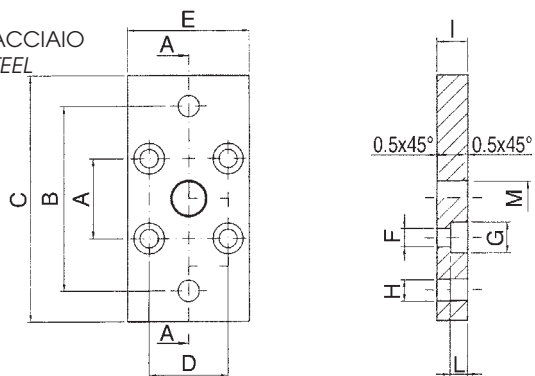
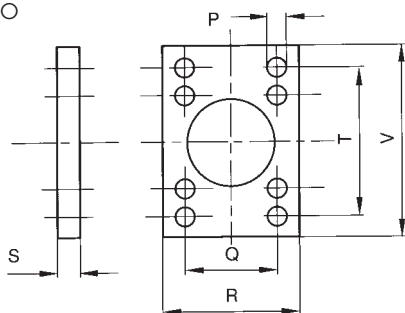

Componenti di fissaggio | Mounting Accessories

 MATERIALE: ACCIAIO
 MATERIAL: STEEL

QFL

FLANGIA - FLANGE

Ø mm.	A	B	C	D	E	F	G	H	I	L	M
12 - 16	18	43	55	18	29	4.5	9	5.5	10	5.4	10
20	22	55	70	22	36	5.5	10	6.6	10	5.4	12
25	26	60	76	26	40	5.5	10	6.6	10	5.4	12

 MATERIALE: ACCIAIO
 MATERIAL: STEEL

VFL

FLANGIA - FLANGE

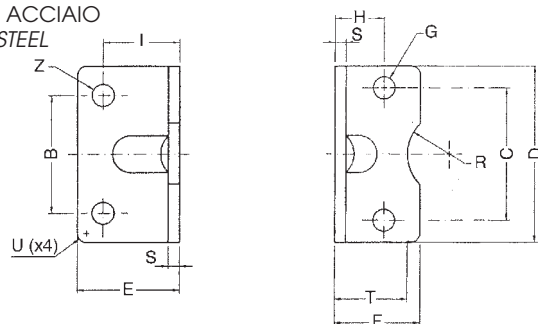
Ø mm.	P	Q	S	R	T	V
32	7	32	10	45	64	80
40	9	36	10	52	72	90
50	9	45	12	65	90	110
63	9	50	12	75	100	120
80	12	63	16	95	126	150
100	14	75	16	115	150	170

 MATERIALE: ACCIAIO
 MATERIAL: STEEL

QCP

PIEDINO BASSO - LOW-RISE PEDESTAL

Ø mm.	C	B	D	E	F	G	H	I	S	T	R	U	Z
12 - 16	18	18	30	17.5	17.5	4.4	13	13	3	15	9	2	5.5
20	22	22	36	22	22	5.4	16	16	4	17	10	2	6.6
25	26	26	40	22	23	5.4	17	16	4	19	11	2	6.6