

**MATERIALE: ACCIAIO**  
**MATERIAL: STEEL**

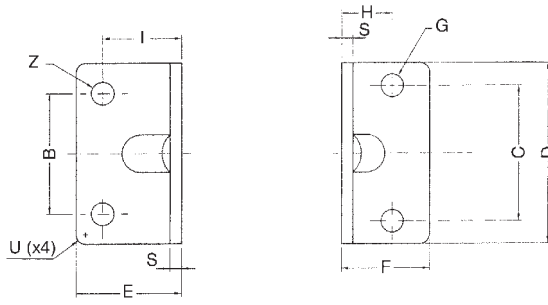

**QCP**

**PIEDINO BASSO- LOW-RISE PEDESTAL**

Ø mm.	C	B	D	E	F	G	H	I	S	U	Z
<b>40</b>	42	42	60	28	29.5	6.6	21.5	20	5	5	9
<b>50</b>	50	50	68	32	30	9	22	24	6	5	9
<b>63</b>	62	62	84	39	39	9	28.5	27	6	5	11
<b>80</b>	82	82	102	36.5	36.5	11	24.5	30	8	5	11
<b>100</b>	103	103	123	38.5	38.5	11	26.5	33	8	5	13.5