

Componenti di fissaggio | Mounting Accessories

MATERIALE: ACCIAIO
MATERIAL: STEEL

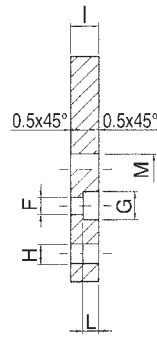
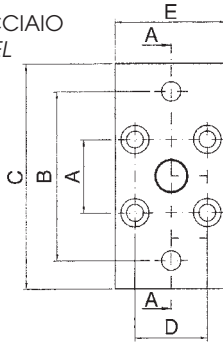

QFL

FLANGIA - FLANGE

Ø mm.	A	B	C	D	E	F	G	H	I	L	M
12 - 16	18	43	55	18	29	4.5	9	5.5	10	5.4	10
20	22	55	70	22	36	5.5	10	6.6	10	5.4	12
25	26	60	76	26	40	5.5	10	6.6	10	5.4	12