

MATERIALE: ACCIAIO  
MATERIAL: STEEL

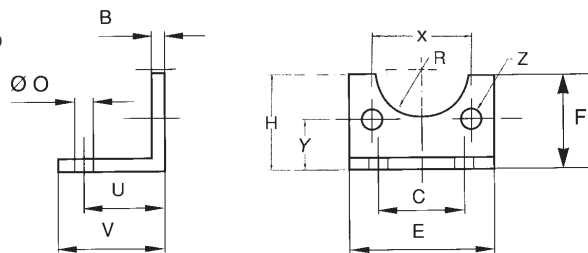

**VCP**

**PIEDINO BASSO - LOW - RISE PEDESTAL**

$\varnothing$ mm.	B	C	E	F	O	U	V	R	Z	X	Y	H
<b>32</b>	4	32	45	30	7	24	35	15	7	32.5	15.75	32
<b>40</b>	4	36	52	30	10	28	36	17.5	7	38	17	36
<b>50</b>	5	45	65	36	10	32	47	20	9	46.5	21.75	45
<b>63</b>	5	50	75	35	10	32	45	22.5	9	56.5	21.75	50
<b>80</b>	6	63	95	47	12	41	55	22.5	11	72	27	63
<b>100</b>	6	75	115	53	14.5	41	57	27.5	11	89	26.5	71
<b>125</b>	8	90	140	70	16.5	45	70	30	14	110	35	90