

Valvole a Sfera / Ball Valves

Le valvole a sfera a passaggio totale sono valvole di intercettazione del tipo ON-OFF, adatte a grandi portate. L'apertura e la chiusura avvengono manualmente agendo sull'alberino di comando della sfera con l'apposita maniglia o mediante una chiave.

The ball valves full port are shutoff valves type ON-OFF, suitable for high flow rate. The opening and closing functions are made by hand, acting on the control spindle of the ball with the handle, or operated with a spanner.

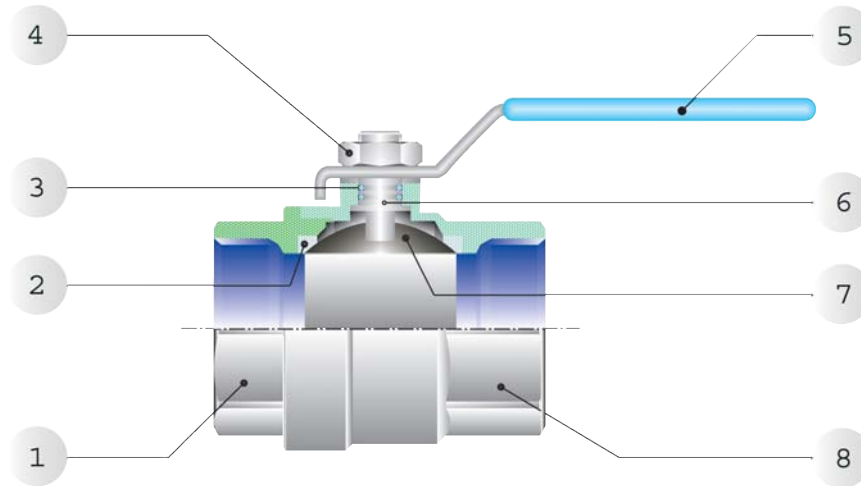

Scheda Materiali / Specifications

- 1 Raccordo in Ottone Nichelato
- 2 Guarnizione sede sfera in PTFE
- 3 Guarnizione asta in NBR
- 4 Dado per leva in Acciaio
- 5 Leva di manovra in acciaio plastificato
- 6 Asta di manovra in ottone nichelato
- 7 Sfera in ottone cromato
- 8 Corpo in ottone nichelato

- 1 Nickel-plated Brass Fitting
- 2 PTFE Seats
- 3 NBR Stem Seal
- 4 Steel Nut for lever
- 5 Steel plastified Lever handle
- 6 Nickel-plated Brass Stem
- 7 Chrome Nickel-plated Brass Ball
- 8 Nickel-plated Brass Body

**** DIAGRAMMA PRESSIONE-TEMPERATURA**
PRESSURE-TEMPERATURE RATINGS DIAGRAM

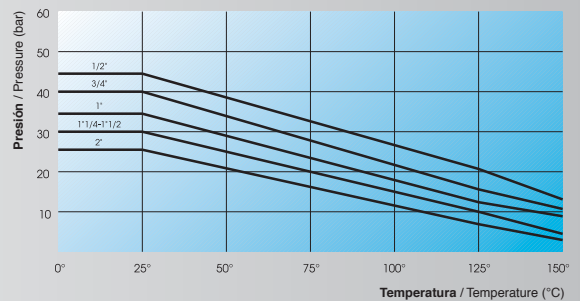

Filettature / Thread

Gas Cilindrica conforme ISO 228 classe A.
Parallel gas in conformity with ISO 228 class A.

Tubi di collegamento / Connections tube

Tubi metallici in genere, raccorderia varia.
Tubes made in metal in general and various fittings.

6067

VALVOLA A SFERA, FEMMINA G ISO 228 - FEMMINA G ISO 228 - BALL VALVE, FEMALE G ISO 228 - FEMALE G ISO 228

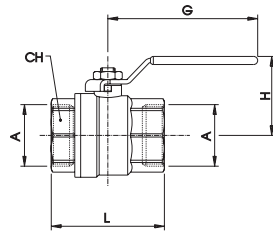

A	DN	CH	L	G	H	Conf. Pack.
1/2	15	25	46	75	47.5	10
3/4	20	31	56.5	75	51	10
1"	25	38	65.5	110	63	5
1"1/4	32	48	77	110	68.5	2
1"1/2	40	54	88.5	140	84.5	1
2"	50	67	101.5	140	92.5	1

ART.6067:

Fluidi: Aria compressa, acqua, olii.

Fino al DN20: Valgono le condizioni riportate nel diagramma Pag. 7.18**

Dal DN25 al DN50, Pressione Max: 18 bar

Fluid: Compressed air, water, oil.

DN 15 and 20: Use Diagram condition Pag. 7.18**

From DN25 to DN50, Max Pressure: 18 bar