



G

Serie / Series

Ghilux

Valvole a sfera
Ball valves

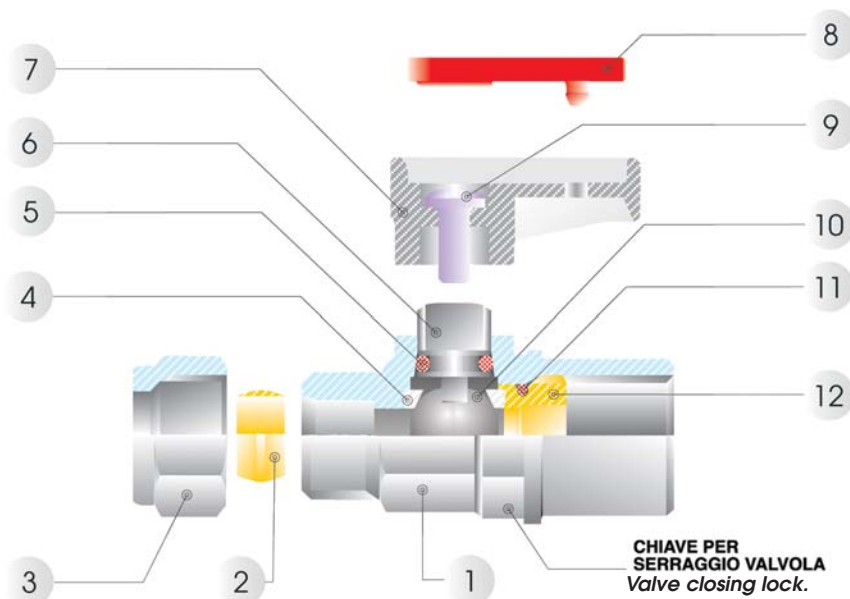

OMOLOGAZIONE
BG / EC-87 / 99 / 106
COMPLY WITH EN - 331

Scheda Materiali | Specifications

- | | |
|---|---|
| 1 Corpo in Ottone cromato | 1 Chrome Nickel-plated Brass Body |
| 2 Ogiva in Ottone (PTFE a richiesta) | 2 Brass Olive (if Requested PTFE) |
| 3 Dado in Ottone cromato | 3 Chrome Nickel-plated Brass Nut |
| 4 Guarnizione sede sfera in PTFE | 4 PTFE Seats |
| 5 Guarnizione O-RING in NBR 70 (FKM a richiesta) | 5 NBR 70 Seal O-RING (FKM if required) |
| 6 Albero in Ottone cromato | 6 Chrome Nickel-plated Brass Spindle |
| 7 Maniglietta in PA66 Caricato vetro | 7 PA66 Glass reinforced Handle |
| 8 Piastrina in PA6 | 8 PA6 Plate |
| 9 Vite in acciaio | 9 Steel Screw |
| 10 Sfera in Ottone cromato | 10 Chrome Nickel-plated Brass Ball |
| 11 Guarnizione O-RING in NBR 70 (FKM a richiesta) | 11 NBR 70 Seal O-RING (FKM if required) |
| 12 Ghiera o raccordo in Ottone | 12 Brass Fitting |

Pressioni | Pressures

Pressione minima / Minimum Pressure: 0.99 bar (0.099MPa)
Pressione massima / Maximum pressure: 20 bar (2 MPa)

Temperature | Temperatures

Temperatura minima / Minimum temperature: -20 °C
Temperatura massima / Maximum temperature: +80 °C

Filettature | Threads

Gas conica conforme ISO 7.1, BS 21, DIN 2999 / Tapered gas in conformity with ISO 7.1, BS 21, DIN 2999.
Gas cilindrica conforme ISO 228 Classe A / Parallel gas in conformity with ISO 228 Class A.

Tubi di collegamento | Connection Tubes

Tubi in rame, tubi metallici in genere, raccorderia varia. PA6, PA11, ecc. utilizzando l'apposita bussolina di rinforzo art. 10770.

Tubes made in copper, metal in general and various fittings. PA6, PA11 etc. with an inside support bush art 10770.

Fluidi compatibili | Fluids

Aria compressa, acqua, oli.
1° e 2° famiglia di gas a media pressione.
3° famiglia di gas a bassa pressione.

Compressed air, water, oils.
1st and 2nd family gases at medium pressure.
3rd family gases at low pressure.

DIAGRAMMA PRESSIONE-TEMPERATURA
PRESSURE-TEMPERATURE RATINGS DIAGRAM

- PTFE + NBR
- PTFE + FKM

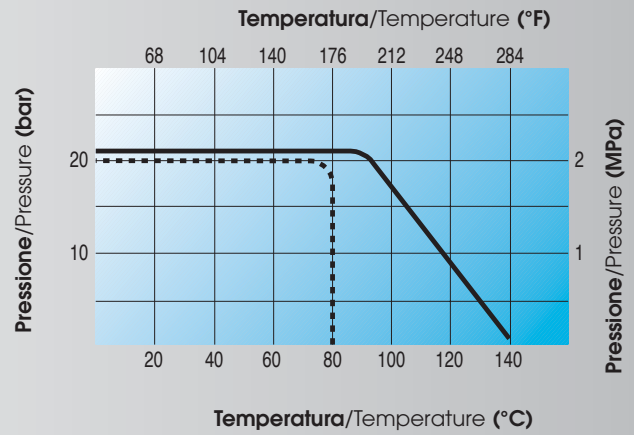

CURVE CARATTERISTICHE DI FLUSSO PER ARIA
RELATIVE ALLE VALVOLE A SFERA GHILUX ART. 6400 FEMMINA-FEMMINA
CHARACTERISTIC CURVES OF FLOW FOR AIR
PERTINENT TO THE BALL VALVES GHILUX ART. 6400 FEMALE-FEMALE

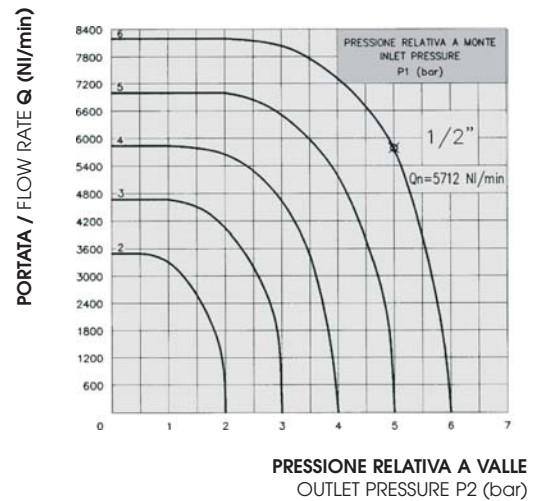
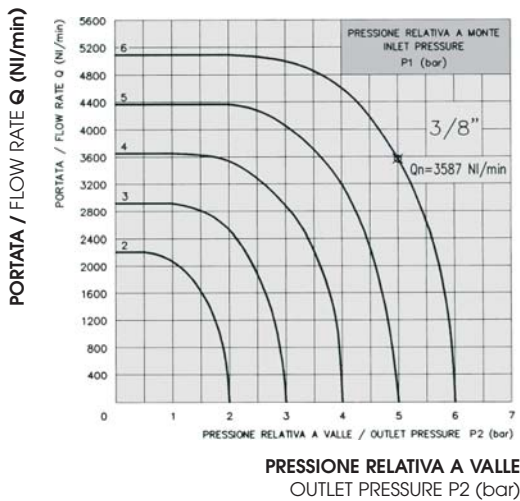
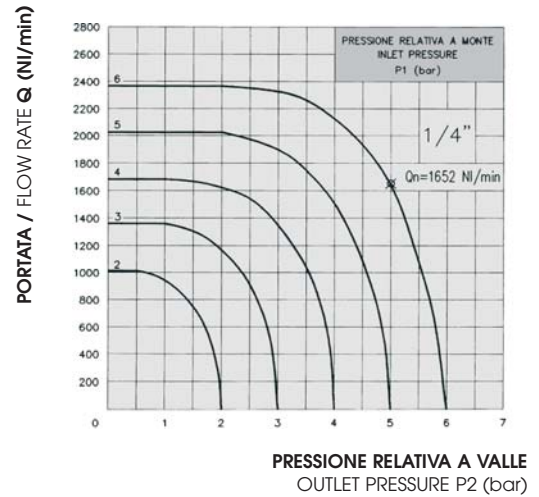
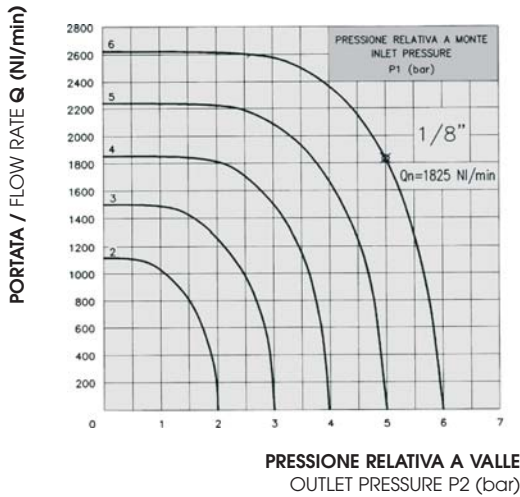

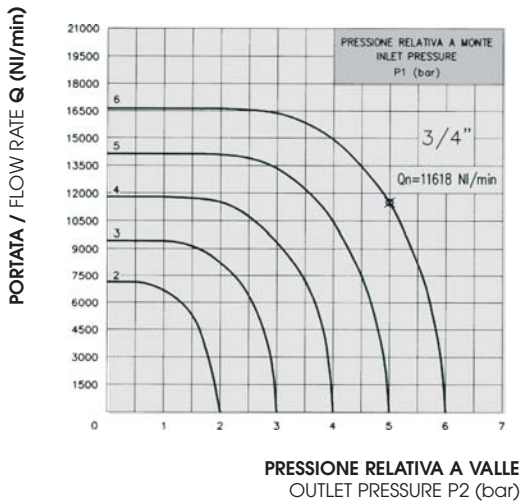

Sui vari diagrammi é evidenziato il valore di Q_n relativo ad una pressione $P_1 = 6$ bar e ad una pressione $P_2 = 5$ bar.

On the different diagrams is marked the value of flow rate Q_n pertinent to a pressure $P_1 = 6$ bar and to a pressure $P_2 = 5$ bar.

CERTIFICATO DI PROVA N° 36794 RILASCIATO DALL' "ISTITUTO GIORDANO" IN DATA 13/06/1990.

TEST CERTIFICATE N° 36794 ISSUED BY THE "ISTITUTO GIORDANO" ON THE 13/06/1990.

DIAGRAMMA DELLA CARATTERISTICA PORTATA-PERDITA DI CARICO RELATIVO ALLE VALVOLE A SFERA GHILUX ART. 6400 FEMMINA-FEMMINA PER ACQUA
DIAGRAM OF THE FLOW RATE AND PRESSURE DROP CHARACTERISTICS PERTINENT TO THE BALL VALVES GHILUX ART. 6400 FEMALE-FEMALE FOR WATER

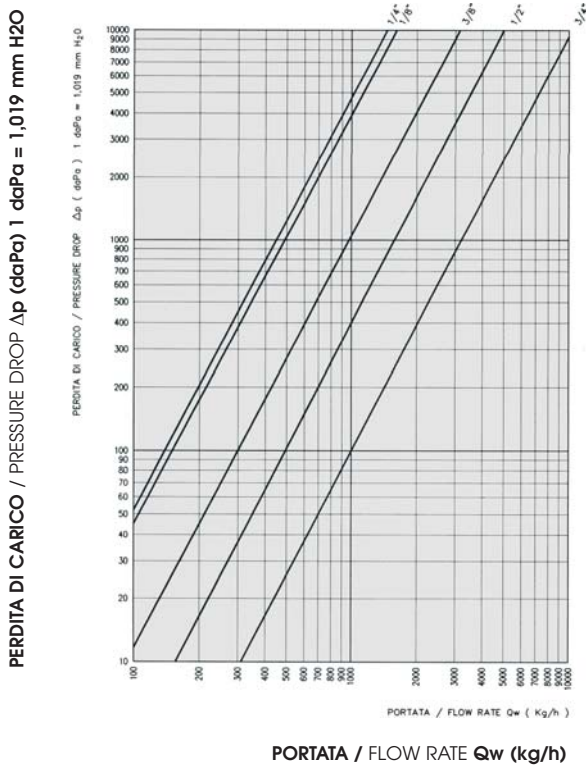

COEFFICIENTI DI PORTATA Kv
FLOW RATE FACTORS Kv

Riportiamo in tabella il coefficiente di portata K_v delle valvole a sfera GHILUX, ricordando che tale coefficiente rappresenta la quantità d'acqua che attraversa la valvola nell'unità di tempo (Kg/h) alla temperatura di 15.5° C e che determina una caduta di pressione unitaria.

On the following table we specify the flow rate factor K_v of the ball valves GHILUX, we remind You that this factor represent the quantity of water that cross the valve in the unit time (Kg/h) at the temperature of 15.5° C and it determines a drop of unitary pressure.

Misura Size	Coefficiente di Portata Idraulica Factor of hydraulic flow rate K_v (Kg/h)
1/8"	1614
1/4"	1461
3/8"	3164
1/2"	5051
3/4"	10274

COME ORDINARE

Le valvole a sfera standard della serie GHILUX prevedono:

- Trattamento superficiale di CROMATURA
- Ogiva in OTTONE
- Maniglia CORTA
- Piastrina ROSSA

Gli articoli standard possono essere ordinati specificando solo CODICE, MISURA, QUANTITA'.

Ogni variazione allo standard deve essere specificata sull'ordine mediante una descrizione (es. Maniglia Lunga, Piastrina Verde, ecc.).

HOW TO ORDER

The ball valves GHILUX series are supplied with:

- Surface treatment of CHROME-NICKEL PLATED
- BRASS Olive
- SHORT Handle
- RED Plate

To order the standard items simply specify the ARTICLE CODE, SIZE and QUANTITY.

Every kind of changes must be specified on the order using a description (ex. LONG handle, GREEN plate, etc.).

6430

TUBO - FEMMINA G ISO 228 - TUBE - FEMALE G ISO 228

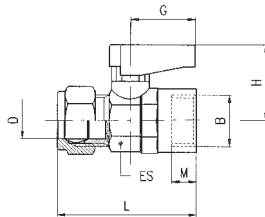

D	B	DN	ES	M	L	G	H	Conf. Pack.
6	- 1/8	5.5	14-15	7	41	19	21	25
8	- 1/8	5.5	14-15	7	43	19	21	25
8	- 1/4	5.5	14-15	8	43	19	21	25
10	- 3/8	8	18-19	9	48	19	22	10
12	- 3/8	8	18-19	9	49	19	22	10
14	- 1/2	10	22-23	10	55.5	26	30.5	10
15	- 1/2	10	22-23	10	55.5	26	30.5	10
16	- 3/4	14	28-30	12	63.5	26	33	5
18	- 3/4	14	28-30	12	63.5	26	33	5

